

| DWG REF | QTY | PART NUMBER | DESCRIPTION | MATERIAL |
|--|-----|---------------|---------------------------|---|
| SHELL | | | | |
| 1 | 1 | ORDER SECTION | SHELL | Filament Wound Epoxy/Glass composites - Head locking grooves integrally wound in place. |
| 2 | A/R | | F/C Port | CF3M* |
| 3 | A/R | | F/C Port Seal | Ethylene Propylene . |
| HEAD - NON CODED | | | | |
| 4 | 2 | 96244 | Elliptical Head Assy. | Engineering Thermoplastic. |
| 5 | 2 | 96000 | Head Seal | Ethylene Propylene - O - Ring |
| HEAD INTERLOCK | | | | |
| 6 | 2 | 47336 | Quick Release Spiral Ring | 316 Stainless Steel. |
| VESSEL SUPPORT | | | | |
| 7 | * 2 | 52169 | Saddle | Engineering Thermoplastic. |
| 8 | * 2 | 45042 | Strap Assy. | 304 Stainless Steel-PVC Cushion. |
| 9 | 4 | 46265 | Strap screw. | 5/16-18 UNC, 18-8 Stainless Steel. |
| ELEMENT INTERFACE | | | | |
| 10 | 2 | A/R | Adapter | Engineering Thermoplastic. |
| 11 | 2 | 52245 | Adapter seal | Ethylene Propylene - O - Ring |
| 12 | 4 | A/R | PWT Seal | Ethylene Propylene - O - Ring |
| 13 | 1 | 97014 | Thrust Cone | Engineering Thermoplastic. |
| * 3 each furnished with length code 4,5,6,7 & 8. | | | | |

VIEW AT CENTER SUPPORT
 CENTER VESSEL ON 2 OR 3 SUPPORTS
 AT SPAN(S) "S": 3 SUPPORTS REQUIRED
 FOR LENGTHS 4 AND OVER

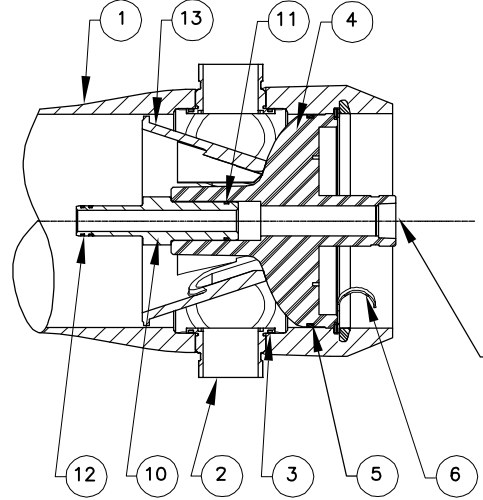

CAUTION: INCORRECT MANIFOLDING WILL CAUSE SEVERE LOCAL STRESS AROUND PORT AND MAY RESULT IN LEAKS AND PREMATURE FAILURE; TAKE EVERY PRECAUTION LISTED ON REVERSE, SEE INSTALLATION INSTRUCTIONS FOR FURTHER DETAILS

WARNING
 INTERNAL PORT PRESSURE NOT TO EXCEED 125 PSI.

SECTION THROUGH END CLOSURE

- NOTES:-
- ♦ MAX. ANGULAR VARIATION BETWEEN ANY PORTS ±0.5°.
 - ♦ DIMENSION IN INCHES (MM APPROX.)
 - ♦ SHELL EXTERIOR COATED WITH WHITE, HIGH GLOSS POLYURETHANE PAINT.
 - ♦ NOT TO BE USED FOR CONSTRUCTION UNLESS CERTIFIED.
 - ♦ ITEM 13 DOWNSTREAM ONLY.
 - ♦ GRADE CF3M PER ASME SA-351/316L AS PER SA-479.

| Dash Length | L IN(MM) | P IN(MM) | S IN(MM) | Approx Weight LB(KG) |
|-------------|---------------|------------|--------------|----------------------|
| -1 | 59.75 (1518) | 47 (1194) | 20X1 (502) | 84 (38) |
| -2 | 99.75 (2534) | 87 (2210) | 56X1 (1422) | 106 (48) |
| -3 | 139.75 (3550) | 127 (3226) | 80X1 (2032) | 128 (58) |
| -4 | 179.75 (4566) | 167 (4242) | 64X2 (1626) | 150 (68) |
| -5 | 219.75 (5582) | 207 (5258) | 78X2 (1981) | 172 (78) |
| -6 | 259.75 (6598) | 247 (6274) | 92X2 (2337) | 194 (88) |
| -7 | 299.75 (7614) | 287 (7290) | 106X2 (2692) | 216 (98) |
| -8 | 339.75 (8630) | 327 (8306) | 120X2 (3048) | 238 (108) |

| | | | |
|---------------|--------------|---|--------------|
| DRAWN DATE | KR 05 NOV 07 | MODEL - 80S60(NON-CODED) MEMBRANE HOUSING | |
| CHECKED DATE | MD 05 NOV 07 | ECN 3126 | REV. K |
| APPROVED DATE | SS 05 NOV 07 | DWG. NO. 99174 | SHEET 1 OF 2 |
| | | SCALE NONE | SIZE A3 |

RATING:

DESIGN PRESSURE..... 600 PSIG at 190°F
 (4.1 MPa at 88°C)
 MIN. OPERATING TEMP..... 20°F
 (-7°C)
 FACTORY TEST PRESSURE..... 900 PSIG
 (6.2 MPa)
 QUALIFICATION PRESSURE..... 3600 PSI
 (24.8 MPa)

INTENDED USE:

The CodeLine 80S60 Non Coded Fiberglass RO Pressure Vessel is designed for continuous, long term use as housing for reverse osmosis membrane elements to desalt typical brackish waters at pressures up to 600 psi. Any make of eight-inch nominal diameter spiral-wound element is easily accommodated; the appropriate interfacing hardware for the element specified is furnished with the vessel.

The Shell of CodeLine 80S60 Non Coded is designed in accordance with the engineering standards of the Boiler and Pressure Vessel Code of the American Society of Mechanical Engineers (ASME) Code.

The CodeLine 80S60 Non Coded must be installed operated and maintained in accordance with the listed precautions and good industrial practice to assure safe operation over a long service life.

The high performance Filament wound FRP shell must be allowed to expand under pressure; undue restraint at support points or piping connections can cause leaks to develop in the shell. This side-ported vessel requires special precautions in mounting and connection to piping so that the vessel will not be subjected to excessive stress due to bending moments acting at the side openings in the fiberglass shell. The end closure, incorporating close fitting, interlocking metal components, must be kept dry and free of corrosion; deterioration can lead to catastrophic mechanical failure of the head.

Pentair Water will assist the purchaser in determining the suitability of this standard vessel for their specific operating conditions. The final determination however, including evaluation of the standard material of construction for compatibility with the specific corrosive environment, shall be the responsibility of the purchaser. Alternate materials with enhanced corrosion resistance are available on special order.

Specifications are subject to change without notice.

PRECAUTIONS:

- DO...read, understand and follow all instructions; failure to take every precaution will void warranty and may result in vessel failure
- DO...mount the shell on horizontal members at span "S" using compliant vessel supports furnished; Shim saddles if required. Tighten hold down straps just snug
- DO...align and center side ports with the manifold header. Correct, causes of misalignment in a row of vessels connected to the same header
- DO...use flexible type IPS grooved-end pipe couplings, at side ports; allow full, 0.125 inch gap between port and piping, and position piping to maximize flexibility of connection.
- DO...provide flexibility in, and support for piping manifolds so that vessel can grow in length under pressure without undue restraint; provide additional flexible joints in large pipes leading to manifold header.
- DO...provide overpressure protection for vessel set at not more than 105% of design pressure
- DO...inspect end closures regularly; replace components that have deteriorated and correct causes of corrosion
- DO... Lubricate seals sparingly, using nonpetroleum Based lubricants, i.e. Parker Super O-lube®, Glycerin or suitable silicone based lubricants.
- DO NOT...work on any component until first verifying that pressure is relieved from vessel
- DO NOT...make rigid piping connections to ports or clamp vessel in any way that restricts growth of fiberglass shell under pressure; ***ΔDIA = 0.015 in. (0.4mm) and ***ΔL = 0.2 in. (6mm) for a length code -8 vessel
- DO NOT... hang piping manifolds from ports or use vessel in any way to support other components
- DO NOT...tighten Permeate Port connection more than one turn past hand tight
- DO NOT... operate vessel without connecting both Permeate Ports internally to complete set of elements or otherwise plug ports internally so that external piping connection is not subjected to feed pressure
- DO NOT...install Spacer on downstream end of vessel
- DO NOT...operate vessel without Thrust Cone installed downstream
- DO NOT...pressurize vessel until double-checking to verify that the Locking Ring is in place and fully seated.
- DO NOT...operate vessel at pressure and temperature in excess of its rating.
- DO NOT...operate vessel with permeate pressure in excess of 125 psi at 190°F (0.86 MPa at 88°C).
- DO NOT...tolerate leaks or allow end closures to be routinely wetted in any way
- DO NOT...operate outside the pH range 3-10.

Distributed By:
APPLIED MEMBRANES INC.
 Industry Leader in RO Expertise and Membrane Applications since 1983™
 2450 Business Park Dr., Vista, CA 92081 ☎ (760) 727-3711 📠 (760) 727-4427
 🌐 www.appliedmembranes.com ✉ sales@appliedmembranes.com

ORDERING:

Using the chart below, please check the features you require and fax them with your purchase order to our customer service department for further processing.
 For optional materials and / or feature not listed below, please consult the factory for pricing and availability

VESSEL LENGTH CODE – please check one

MODEL 80S60 Non Coded -1 -2 -3 -4 -5 -6 -7 -8

MEMBRANE BRAND AND MODEL – please check one and fill in information

- Please supply adapters for the following membrane brand and specific model
 Brand _____ Model _____
- Membrane brand and model information is not currently available, but will be supplied to Pentair Water on or before the following date. ___ / ___ / ___

CERTIFICATION REQUIRED

- CE Marked
- Standard, Certified by Pentair water.

MATERIAL OPTIONS – please check one

- Standard: all materials as per drawing 99174 on the previous page
 NOTE: The options listed below will increase the vessel price. Call factory for pricing details.
- Option: Customer specified Material of Construction.(Please consult factory as these options will affect pricing and vessel lead time)

FEED/CONCENTRATE PORT CONFIGURATION

- Standard – 1½” IPS pipe, grooved ends, with ports in-line
- Optional – Multi-Ports™

Using the instructions in Order Specification Sheet #99007
 Please fill out your feed port configuration in the space below.
 List port location first, followed by port size for each choice.
 2.5” Ports not available in 90° Configuration

Serial number end

Opposite end

PERMEATE PORT CONFIGURATION:

- Standard. 1” FNPT & 1.5” IPS GROOVED.
- Optional. 1”BSPF/JIS F-Parallel Thread & 1.5” IPS GROOVED.

| PORT SIZE CODE | |
|----------------|-----------------|
| D | 1½” GROOVED END |
| E | 2” GROOVED END |
| F | 2½” GROOVED END |

For complete information on proper use of the vessel
 Please refer to the 80S Series USER’S GUIDE 94182.

