

TRANSFORMERS

Aquatec transformers are specifically designed to power the products in this catalog.

Nominal primary voltages/frequencies, line voltage variations, and system related feed or back pressures may influence your ultimate selection. Our transformers are both current and temperature protected for additional safety protection.

Aquatec pump-transformer combinations are designed to operate at maximum efficiency under a wide range of voltage conditions without overheating or overloading. This can save the end-user thousands of kilowatt hours per year compared to less efficient pumps.

Part No.	Input Voltage	Output Voltage Max. Current	Primary Input Cord Length	Secondary Output Cord Length	Overload Protection
TACS 104-48	100 VAC, 50/60 Hz	24 VAC, 2 A	6 ft.	6 ft.	Thermal Fuse
TACS 114-48	115-120 VAC, 60 Hz	24 VAC, 2 A	6 ft.	6 ft.	Thermal Fuse
TACS 234-48RF	230 VAC, 50 Hz	24 VAC, 2 A	6 ft.	6 ft.	Circuit Breaker, Auto-Reset
TAS 104-19*	100 VAC, 50/60 Hz	24 VAC, 800 mA	None, Plug-In	6 ft.	Circuit Breaker, Auto-Reset
TAS 114-19EP	116-120 VAC, 50 Hz	24 VAC, 800 mA	None, Plug-In	6 ft.	Circuit Breaker, Auto-Reset
TAS 234-19EP	230 VAC, 50 Hz	24 VAC, 800 mA	None, Plug-In	6 ft.	Circuit Breaker, Auto-Reset

REPLACEMENT KITS

Aquatec and its distributors can provide fully assembled replacement kits to allow you to further extend the life of our pump products. These kits are available in three different configurations: upper housing assembly, valve housing assembly and lower housing assembly

5-Chamber Pump

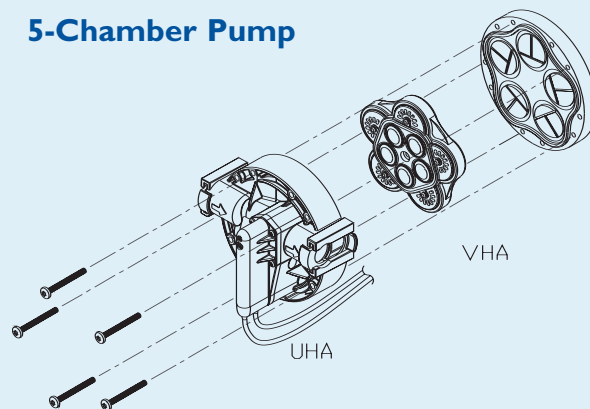

3-Chamber Pump

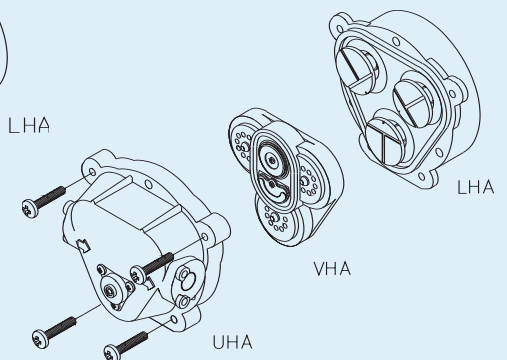

UHA: Upper Housing Assembly • **VHA:** Valve Housing Assembly • **LHA:** Lower Housing Assembly

Distributed by Applied Membranes, Inc. | www.appliedmembranes.com | (760) 727-3711 | USA