

Performance Data Information

Membrane Production:	
502026	15 gallons (57 liters) per day*
502026-HF	50 gallons (189 liters) per day*
Rated Membrane Life:	1 Year
Carbon Pre-Filter:	Chlorine, Taste, and Odor
Rated Carbon Block Life:	3 months or 400 gallons (1,512 liters) of treated water

*Based on a feed pressure of 60psi (approximately 4 bar), water temperature of 77°F (25°C), and 500ppm feed TDS.

**The life of the RO membrane varies based on feed water quality and usage. Product water should be tested periodically to ensure membrane performance. The RO membranes should be replaced every 6 months to 2 years.

Membrane performance and water production rates are dependent on incoming water conditions. Your actual performance may vary. The PuroSmart RO System should only be used on municipal water supplies or those that have been determined to be microbiologically safe.

Warranty

The Limited Warranty covers parts needed to repair any supplied item that proves to be defective in material, workmanship, or factory assembly. The limited warranty covers PuroSmart product for one calendar year from date of purchase. The following items are subject to exclusions: membrane, filter, o-rings, flow restrictor, and all other parts or components that require regular replacement. This limited warranty applies only to the original purchaser.

Disclaimers

The Limited Warranty does not cover defects caused by improper use, alteration, lack of regular maintenance, or as a result of fouling due to hydrogen sulfide, silica, scaling from excessive hardness, or membrane breakthrough due to excessive chlorine. The manufacturer does not assume responsibility for damage caused by accident, fire, or acts of God. Manufacturer is not responsible for damages incurred through improper use of these products or instructions.

Incidental and Consequential Damages

The manufacturer does not assume responsibility for payment of incidental and consequential damages as a result of the failure of this unit to comply with expressed or implied warranties.

All Other Warranties and Damages

There are no warranties established, expressed, implied or statutory, including the warranty of merchantability, except those set forth above or any performance warranty which is attached to this order.



Installation Guide for Countertop Systems



PSCT15 (15 GPD) & PSCT50 (50 GPD)

Reverse Osmosis Drinking Water System

Congratulations on your purchase of a PuroSmart™ System by Applied Membranes, Inc. (AMI). Your PuroSmart has been designed for effortless installation, operation, and maintenance. Please read the following instructions carefully before putting your PuroSmart into operation, as we want you to enjoy all the benefits of your new product.

How the Product Works

The patented PuroSmart is the only faucet-mounted reverse osmosis (RO) system that includes carbon/sediment pre-filtration as an integral part of the filtration process. The carbon/sediment pre-filter removes sediment above 20 microns as well as chlorine. From the pre-filter, the feed water flows to the reverse osmosis membrane which, using a molecular separation process, divides the water into two streams: the product and concentrate streams. The product stream contains the purified drinking water, while the concentrate stream contains all of the impurities down to the molecular size (sub-micron) that are removed by the RO membrane. Unlike typical filtration products, these impurities are continually flushed out of the system. The PuroSmart will provide you with the finest quality drinking water, being virtually unsurpassed by any home water filtration device or bottled drinking water found on the market today.

Directions for Use

Be sure to observe the following directions when operating your PuroSmart:

- Maximum feed water pressure should not exceed 100 psi (6.9 bar);
- For use with potable water only;
- Only use cool water (< 100°F/38°C);
- Allow system to run at least 2 hours before storing drinking water; Keep unit from freezing temperatures.

Document ID # PSCT Rev. 09/12/18

Getting Started - Your package contains:

- ① PuroSmart System (with RO Membrane & Carbon/Sediment Pre-Filter inside)
- ② Flow restrictor Assembly with White Tubing
- ③ Diverter Valve (with Gasket & White Tubing)
- ④ 2.5'-foot Long Section of Clear Tubing
- ⑤ Plastic Stand with Mounting Clip & Hardware

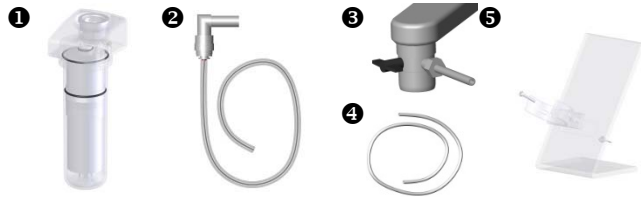

Installation

Note: PuroSmart uses quick-connect fittings. To make a connection, ensure the tubing is fully inserted all the way to the tube stop. Pull the tube to check it is secure.

To disconnect tubing, push the collet square against the fitting. With the collet held in this position, the tube can be removed.

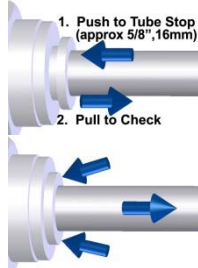

Step 1: Remove the aerator from the kitchen sink faucet. (Figure 1)



Step 2: Place the gasket into the diverter valve and screw the assembly onto the faucet. (Figure 2)

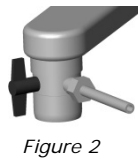

Step 3: Assemble the plastic stand (Phillips-head screwdriver required) and mount the PuroSmart.



Step 4: Install the 2.5' clear tubing into the connector on the top right side connection of the PuroSmart. (Figure 3)

Step 5: Remove the blue locking clip then connect the Diverter Valve Tubing into the connector at the top of the PuroSmart, then re-install the locking clip. (Figure 4)



Step 5: Place the system in the sink, turn the diverter valve knob to the horizontal position, and run cold water to flush the PuroSmart for a few seconds before installing the flow restrictor.

Step 6: Turn off the water and install the Flow Restrictor Assembly. Push the flow restrictor assembly elbow into the connection at the bottom of the PuroSmart. (Figure 5)



Step 7: You are now ready to begin making water. You must run your PuroSmart for 2 hours and discard the first amount of water produced in this period. Using a storage container, you can collect water made by the PuroSmart any time you need water.



PuroSmart System Diagram

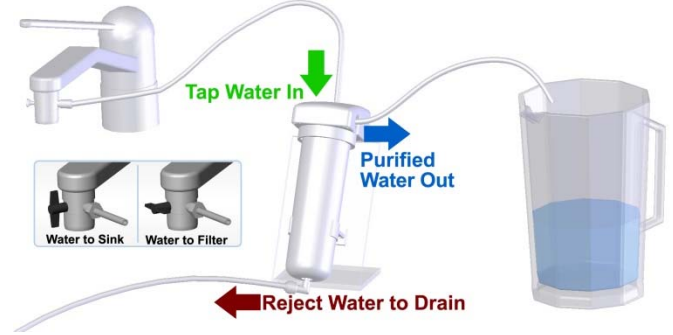

Maintenance

Your PuroSmart RO System was designed to be virtually maintenance free. Simply follow these recommendations and your PuroSmart should last for years.

- To protect the RO membrane, the carbon block pre-filter should be replaced every 3 months or 400 gallons of treated water.
- To ensure the highest quality drinking water, replace the RO membrane every 12 months.
- When not in use, your PuroSmart can be disconnected, placed in a plastic bag, and stored in the refrigerator.

Replacement Parts

Carbon Pre-Filter (3-Pack) 502025-3	RO Membrane 15 GPD: 502026 50 GPD: 502026-HF	Flow Restrictor 15 GPD: 502036 50 GPD: 502036-HF
Diverter Valve 502275	Feed Connector 200476-1	Head Assembly 502211
Sump Vessel 502267	Sump O-Ring 502001-2	Pre-Filter O-Ring 502003
		Feed Inlet O-Ring 500205