

4

3

2

1

BEARING PLATE PART NUMBERS		
PERMEATE PORT SIZE	ALUMINIUM	SS316L
1.0"/1.25"	96157	96476
1.5"	96411	97373

SEALING PLATE PART NUMBERS	
Standard used for Aluminium BP	96159
Optional used for SS316L BP	97404

PERM PORT RETAINER RING & PORT NUT PART NUMBERS		
1.0" / 1.25"	Standard Port nut	45066
1.5"	Port Retainer Ring	45247

STRAP ASSEMBLY PART NUMBERS		
SS304	SS316	SS316L
45042	46926	94371

F/C PORT & SEAL PART NUMBER				
SIZE	*CF3M	**CD3MN	***CD3MWCuN	SEAL
3"	96120	97408	96327	96119
2.5"	96229	97407	96385	96079
2.0"	96485	97406	96645	96078
1.5"	96564	97405	96469	96077

PERMEATE PORT PART NUMBERS & PERMPORT TO F/C PORT OFFSET DISTANCE											
SIZE	MATERIAL	FNPT		MNPT		BSPTF		BSPTM		IPS GROOVED	
		PART NUMBER	DIM "A"	PART NUMBER	DIM "A"	PART NUMBER	DIM "A"	PART NUMBER	DIM "A"	PART NUMBER	DIM "A"
1.0"	NORYL	96161	6.008	97378	7.008	97664	6.008	97384	7.008	97689	7.238
	SS316L	97247	6.008	97379	7.008	97382	6.008	97385	7.008	97388	7.308
	#ZERON 100	97295	6.008	97380	7.008	97383	6.008	97386	7.008	97389	7.308
1.25"	NORYL	NA	NA	97665	7.008	NA	NA	97666	7.008	97667	7.238
	SS316L	NA	NA	97390	7.008	NA	NA	97392	7.008	97167	7.308
	#ZERON 100	NA	NA	97391	7.008	NA	NA	97393	7.008	97395	7.308
1.5"	NORYL	NA	NA	97668	6.608	NA	NA	97399	6.608	97669	7.238
	SS316L	NA	NA	97397	6.608	NA	NA	97400	6.608	97448	7.238
	#ZERON 100	NA	NA	97398	6.608	NA	NA	97401	6.608	97403	7.238

NOTES

DIMENSION IN INCHES (MM APPROX.)

* GRADE CF3M PER ASME SA-351/316L AS PER SA-479

** GRADE CD3MN AS PER ASME SPEC SA-995 (UNS-J92205)

*** GRADE CD3MWCuN AS PER ASME SPEC SA-995 (J 93380)

GRADE ZERON 100 AS PER ASME SPEC SA-479.

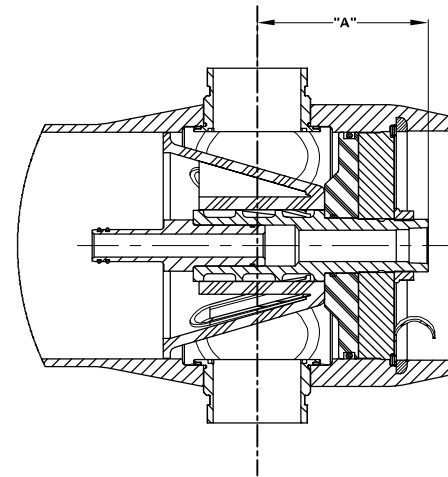

SECTION THROUGH END CLOSURE

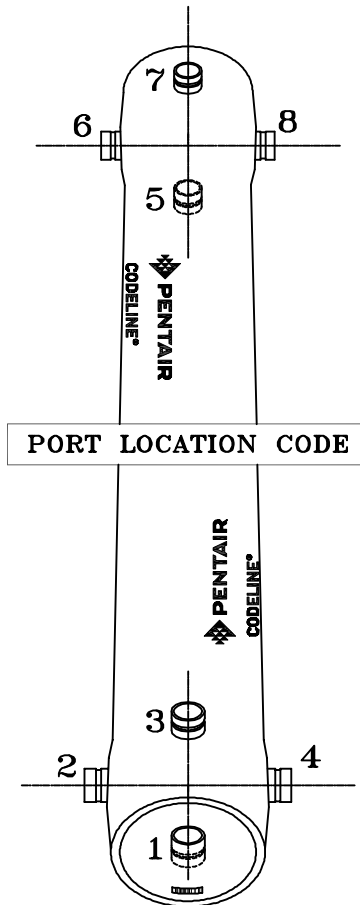

PORT LOCATION CODE

Serial Number End

PENTAIR
CODELINE®

DRAWN	KPS	MODEL - 80H60			
	16 OCT 10	MEMBRANE HOUSING			
CHECKED	RD	DATE	DWG. NO.	REV.	
	16 OCT 10	25APR14	99168	R	
APPROVED	RM	ECN	SCALE	SIZE	SHEET
	16 OCT 10	3236	NONE	A3	3 OF 3

4

3

2

1