





BEARING PLATE PART NUMBERS		
PERMEATE PORT SIZE	ALUMINIUM	SS316L
1.0"/1.25"	96156	97346
1.5"	96879	97350

SEALING PLATE PART NUMBERS	
Standard used for Aluminium BP	96159
Optional used for SS316L BP	97404

PERM PORT RETAINER RING & PORT NUT PART NUMBERS		
1.0" / 1.25"	Standard Port nut	45066
1.5"	Port Retainer Ring	45247

STRAP ASSEMBLY PART NUMBERS		
SS304	SS316	SS316L
45042	46926	94371

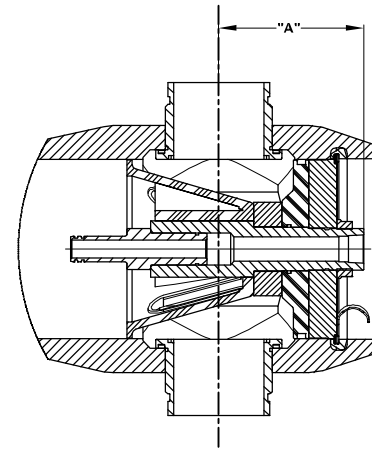

SECTION THROUGH END CLOSURE

F/C PORT & SEAL PART NUMBER				
SIZE	*CF3M	**CD3MN	***CD3MWCuN	SEAL
4"	96266	96884	96647	96265
3"	96567	97443	96659	96119
2.5"	96651	97442	96658	96079
2.0"	96650	97441	96657	96078
1.5"	96649	97440	96656	96077

PERMEATE PORT PART NUMBERS & PERMPORT TO F/C PORT OFFSET DISTANCE											
SIZE	MATERIAL	FNPT		MNPT		BSPTF		BSPTM		IPS GROOVED	
		PART NUMBER	DIM "A"	PART NUMBER	DIM "A"	PART NUMBER	DIM "A"	PART NUMBER	DIM "A"	PART NUMBER	DIM "A"
1.0"	PET/NORYL	96263	6.753	97411	7.753	97414	6.753	97417	7.753	97420	8.053
	SS316L	97410	6.753	97412	7.753	97415	6.753	97418	7.753	97421	8.053
	#ZERON 100	97296	6.753	97413	7.753	97416	6.753	97419	7.753	97422	8.053
1.25"	PET/NORYL	NA	NA	97467	7.753	NA	NA	97425	7.753	97428	8.053
	SS316L	NA	NA	97423	7.753	NA	NA	97426	7.753	97429	8.053
	#ZERON 100	NA	NA	97424	7.753	NA	NA	97427	7.753	97430	8.053
1.5"	PET/NORYL	NA	NA	97431	7.353	NA	NA	97434	7.353	97437	7.983
	SS316L	NA	NA	97432	7.353	NA	NA	97435	7.353	97438	7.983
	#ZERON 100	NA	NA	97433	7.353	NA	NA	97436	7.353	97439	7.983

NOTES

DIMENSION IN INCHES (MM APPROX.)

\* GRADE CF3M PER ASME SA-351/316L AS PER SA-479

\*\* GRADE CD3MN AS PER ASME SPEC SA-995 (UNS J92205)

\*\*\* GRADE CD3MWCuN AS PER ASME SPEC SA-995 (UNS J 93380)

# GRADE ZERON 100 AS PER ASME SPEC SA-479 (UNS S32760).

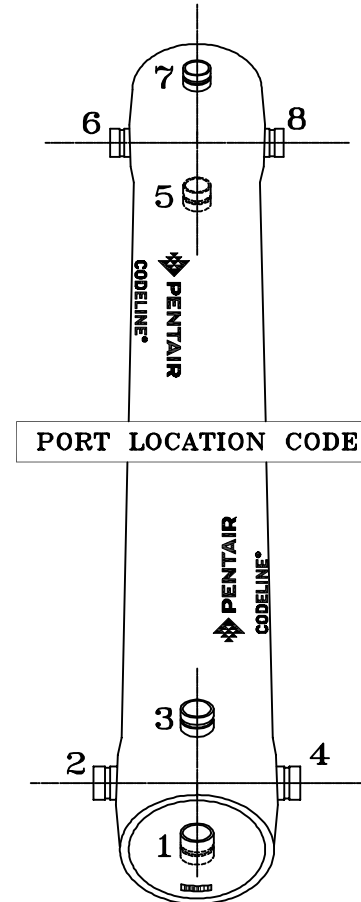

PORT LOCATION CODE

Serial Number End



DRAWN	KPS	MODEL - 80U30			
	16 OCT 10	MEMBRANE HOUSING			
CHECKED	RD	DATE	DWG. NO.	REV.	
	16 OCT 10	17SEP13	99021	K	
APPROVED	RM	ECN	SCALE	SIZE	SHEET
	16 OCT 10	3008	NONE	A3	3 OF 3